

Galvo Scanner (DL.S20)

Features

The galvo scanner DL.S20 is a fast 2-axis beam deflection unit used for quasi-simultaneous welding of polymers. It allows fast positioning of the laser focus in the working field without additional mechanical axes. Used along with the COMPACT Series, the galvo scanner is equipped with a fiber connector, collimating unit and sophisticated marking software.

Package

Includes a mounting plate and fiber-coupled collimating unit, F-Theta optics, supporting marking software and power supply (galvo driver, galvo PC with software, monitor, keyboard and mouse).



Device Specification

Optical	Units	DL.S20	
Wavelength	nm	800 - 1000	800 - 1000
Optical Output Power	W	<500	<500
Focal Length ¹	mm	163	300
Working Field	mm ²	92 x 92	175 x 175
Spot Size (200 µm)	mm	0.9	1.6
Spot Size (400 µm)	mm	1.8	3.2

Fiber Parameters			
Fiber Connector Type ²		SMA, ROB or QBH	
Numerical Aperture	NA	0.22	

Thermal Parameters			
Ambient Temperature	°C	+15 to +35 (non condensing)	
Storage Temperature	°C	5 to +50	

Mechanical of Galvo Scanner			
Dimensions ³	mm ³	270 x 240 x 145	
Weight ³	kg	~7	

Galvo Driver			
Operating Voltage	V	200-240 Single Phase	
Frequency	Hz	50/60	
Power Consumption	kVA	0.020	
Dimensions	mm ³	44 x 483 x 265	
Weight	kg	2.9	

Galvo PC			
Operating Voltage	V	110-240 Single Phase	
Frequency	Hz	50/60	
Power Consumption	kVA	0.07	
Dimensions	mm ³	176 x 483 x 500	
Weight	kg	12	

Galvo Scanner (DL.S20)

Pyro PC

Galvo PC

Operating Voltage	V	110-240 Single Phase
Frequency	Hz	50/60
Power Consumption	kVA	0.07
Dimensions	mm ³	176 x 483 x 250
Weight	kg	16

¹Consult DILAS Industrial Laser Systems for other available options.

²Based on the COMPACT Series output power.

³DL.S20 with a mounting plate, QBH collimating unit and f=163 mm.

Package Dimensions with SMA Fiber Connector

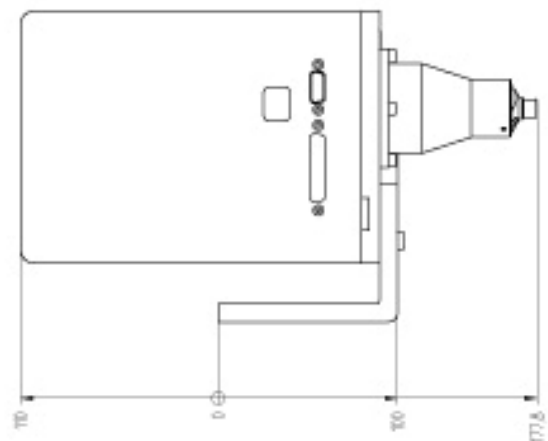
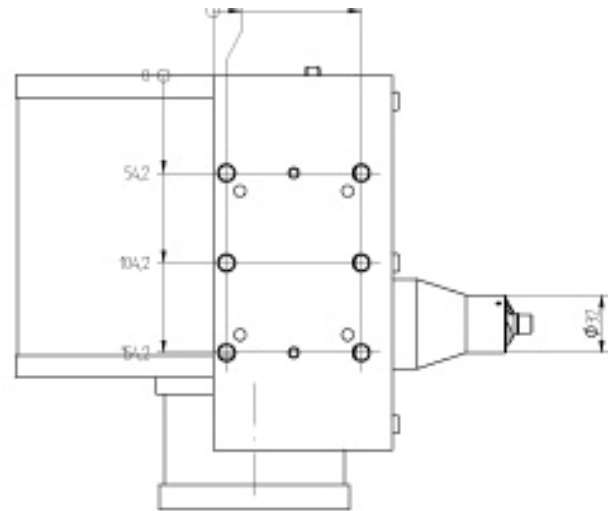
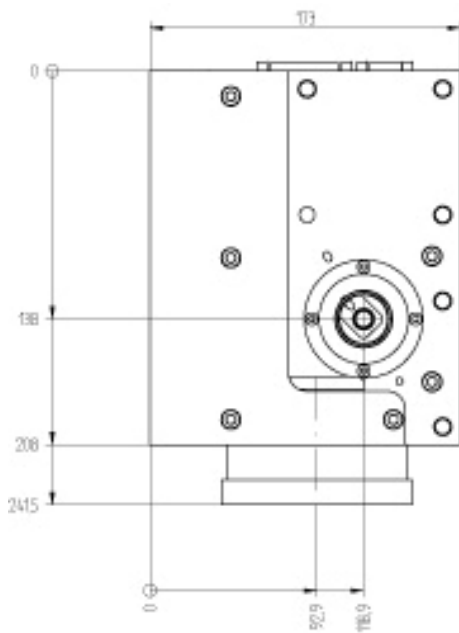

Galvo Scanner (DL.S20)

Package Dimensions with QBH Fiber Connector

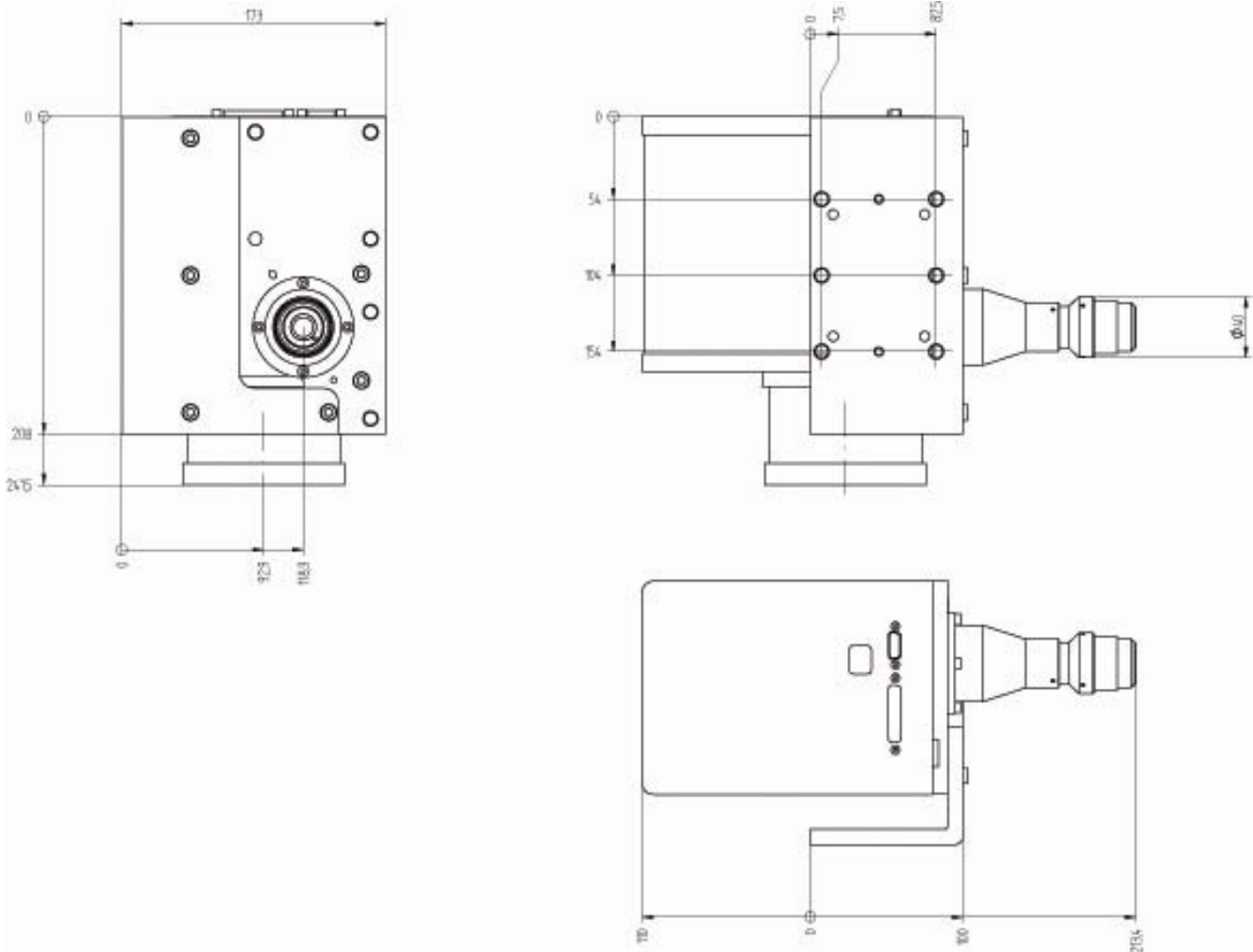

U.S. CFR Regulation

The manufacturer and subsequent sale of laser equipment is under the guidelines governed by the U.S. Center for Devices and Radiological Health (CDRH). In accordance to those guidelines, specifically Subchapter J of the Radiation Standards, 21 CFR, the diode laser is registered as a CLASS 4 laser product.

European Commission

In accordance to EN 60825, Safety of Laser Products, the diode laser is registered as a CLASS 4 laser product.

Products specifications are subject to change without notice. For handling precautions, please reference the general handling instruction manual. For additional information, please contact your local sales representative or visit our website at www.dilas-ils.com.

DILAS Industrial Laser Systems

a division of DILAS Diodenlaser GmbH
Galileo-Galilei-Straße 10
55129 Mainz
Germany

Phone: +49 (6131) 9226 400
Fax: +49 (6131) 9226 444
Email: sales@dilas-ils.com
www.DILAS-ILS.com